

T70-H: DIGITAL OUTPUT DUAL-AXIS TILT SENSOR



■ PRODUCT DESCRIPTION

The T70-H is a dual axis digital tilt sensor by MXMW Hi-Tech Company, integrating industrial standard RTU Modbus and 0x68 hexadecimal protocols; Output RS232, RS485, RS422, TTL optional. Mainly targeting application markets with high limitations in volume, cost, and localization rate. Due to the built-in MEMS micro electromechanical production process tilt unit, it has a small volume, low power consumption, high consistency and stability, strong resistance to external electromagnetic interference, and strong ability to withstand impact and vibration. To manufacture domestically produced equipment and overcome technological barriers in independent research and development.

■ PRODUCT MAIN SPECIFICATION

Parameter	Conditions	T70-H	Unit
Measuring range		±90	°
Measuring axis		X, Y axis	
Zero temperature drift	-40 ~ 85 °C	±0.05	°/°C
Sensitivity temperature coefficient	-40 ~ 85 °C	≤200	ppm/°C
Accuracy	-40 ~ 85 °C	0.1	°
Frequency response	DC response	100	Hz
Power-on start time		0.2	s
Response time		0.01	s
Automatic output rate	5Hz output, (15Hz, 35Hz, 50Hz, 100Hz can be set)		
Output signal	RS232/RS485/RS422/TTL can be ordered		
Average working hours	≥55000 hours/time		
Impact resistance	2600g, 0.5ms, 3 times/axis		
Anti-vibration	10grms、10 ~ 1000Hz		
Insulation resistance	≥100MΩ		
Waterproof level	IP67		
Cable wire	Standard 1.5m length, wear-resistant, oil-proof, wide temperature, shielded cable 4*0.2mm ²		
Weight	55g (excluding packaging box)		

■ PRODUCT DIMENSION

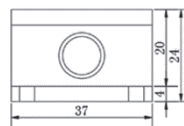
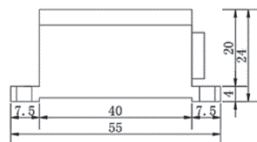
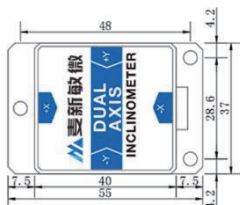

SIZE: L55*W37*H24MM

■ PRODUCT APPLICATION

- High-voltage power line tower monitoring
- Aerial work vehicles
- Pan/tilt leveling
- Charging piles and towers
- Forklifts, engineering dump trucks
- Mining machinery, oil drilling equipment
- Charging piles and towers
- Vehicle overload monitoring
- Medical equipment
- Angle control of various construction machinery